

o These plans are design plans and are provided as a guide only.
 o No guarantee is provided in relation to their accuracy as they will NOT reflect any changes or alterations which may have occurred during construction.
 o Service locations are indicative and MUST be confirmed with the relevant Authority.
 o No responsibility is accepted for any damages or financial loss incurred due to the use of these plans.

WARNING
 BEWARE OF UNDERGROUND SERVICES
 THE LOCATION OF UNDERGROUND SERVICES ARE APPROXIMATE ONLY AND THEIR EXACT POSITION SHOULD BE PROVEN ON SITE. NO GUARANTEE IS GIVEN THAT ALL EXISTING SERVICES ARE SHOWN.

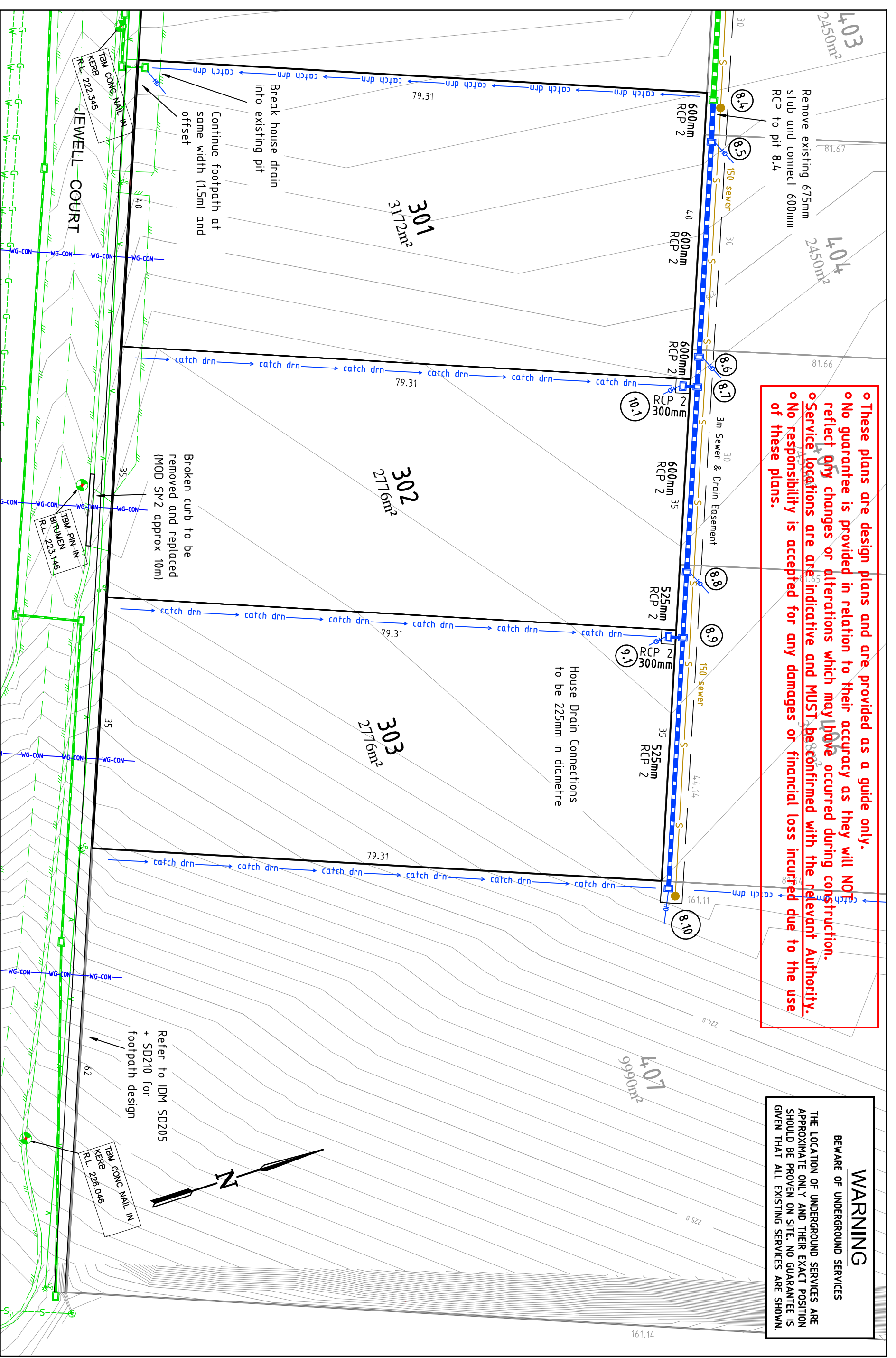

6			
5		Drafted	A.Steel
4		Checked	N.Bowe
3			Jul 2015
2	Construction Issue	Approved	Jul 2015
1	Original Issue		16/07/2015
0	Draft		-
Ver	Revision Description		Date

Notes/Legend
 PLEASE NOTE THAT CONTOURS SHOWN ON PLAN INDICATE THE APPROXIMATE FINISHED SURFACE CONTOUR INTERVAL 0.1m

TERRACO
 Civil Engineers
 Project Managers
 Development Consultants
 ABN 12 681 695 776
 Corner Jewell Court
 & Rowena Street
 Bendigo VIC 3550
 Ph: 03 5442 5799
 Fax: 03 5441 5506
 E: info@terraco.com.au

Scale (m)
 HOR 0 5 10
 1:500
 All lengths are in metres
 and all levels are to Australian Height Datum
 (Original Sheet Size is A3)
 Drawing file: LTO Ref: -
 AMEND: 9/26/2007A

City Of Greater Bendigo - East Bendigo
 Bendigo Brick Pty Ltd
 Brickworks Stage 3
 Layout Plan
 Council Ref: Caliban Ref: Our Ref: Version Sheet
 AMEND: 9/26/2007A SME 164.77 15064 2 4 of 7

Refer to IDM SD205 + SD210 for footpath design

Broken curb to be removed and replaced (MOD SM2 approx 10m)
 House Drain Connections to be 225mm in diameter
 Break house drain into existing pit
 Continue footpath at same width (1.5m) and offset